

EHLEX LED Series

Hazardous location | Edge lit LED exit sign

Key Features

- 1 Emergency battery back-up integral to sign (no additional enclosure required)
- 2 3-hour emergency operation
- 3 Optional battery back-up self-diagnostic feature
- 4 Field replaceable LED circuit boards and drivers with quick disconnects
- 5 Edge-lit sign

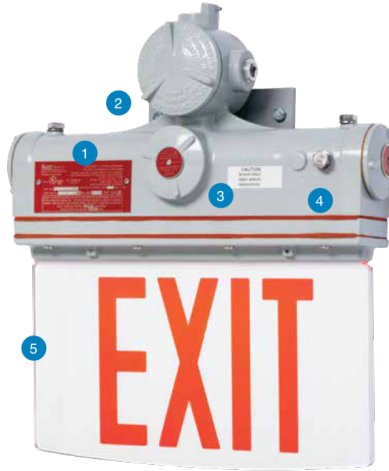

EHLEX Series Fixture Dimensions (inches)

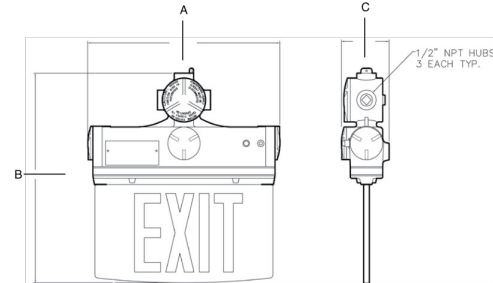

Classifications

- Ⓧ Class I, Division 2, Groups A, B, C & D
- Ⓧ Class II, Division 2, Groups F & G
- Ⓧ Class III
- Ⓧ UL 1598A Marine Outside Type
- Ⓧ Temperature Class (T-Rating)-T6
- Ⓧ Patent No. 7,287,347
- Ⓧ IP65
- Ⓧ ETL Listed

EHLEX Series	Dimensions (inches)			Boxed Weight	Shipping Volume (Boxed Fixture)
	A	B	C		
EHLEX LED Exit Sign	14.88	16.00	3.69	14 lbs.	1.24 cu. ft.

Catalog Number Logic

EHLEX - 2 - G - DT - WP - XX



1
BASIC SERIES
 EHLEX Explosion Proof LED Exit Light
 Class I, Division 2, Groups A, B, C, & D
 Class II, Division 2, Groups F & G
 Class III
 UL 1598A Marine Outside Type
 IP65
 ETL Listed
 Temperature Class (T-Rating)-T6

2
NUMBER OF FACES
 1 = Single Face
 2 = Double Face

3
LEGEND COLOR
 R = Red
 G = Green

4
VOLTAGE/FREQUENCY
 DT = 120/277V 60 HZ
 24 = 220-240V 50/60 HZ
 Other voltages available- consult factory.

5
MOUNTING
 WP = Wall/Pendant Mounting
 EB = End Bracket

6
OPTIONS1
 EM = Emergency Battery Backup
 SD = Self Diagnostics
 X = Exit Legend in Other Languages
 Language Must be Specified

*1Consult factory for pricing.
 2Must be preceded with EM.*

Catalog logic is for explaining catalog number structure only. Not all combinations are possible; consult factory for catalog numbers not listed in charts.

Additional Features

- Ⓧ Wall, pendant and end mounting options
- Ⓧ Alternate exit legend and languages available
- Ⓧ Single- or double-sided option
- Ⓧ Sealed NiCad batteries
- Ⓧ Provided with three (3) 1/2"NPT hubs
- Ⓧ Red or green LED options

Standard Materials

Body:
 A356T6 Aluminum (less than .4% copper content)
 with baked-on gray epoxy finish

Gaskets:
 One-piece Silicone

Sign:
 Acrylic

Hardware:
 Stainless Steel

Maximum Input Power

Red No Battery:
 1.5 Watts
Red With Battery:
 2.5 Watts
Green No Battery:
 2.3 Watts
Green With Battery:
 3.0 Watts

Operating Temperature Range

Temperature Rating:
 T6
Red Legend:
 +10° C Minimum to +55° C Maximum
Green Legend:
 +10° C Minimum to +40° C Maximum